

April 2, 2021

For Immediate Release

[Media Contacts](#)

UPDATE: Northbound I-295 Ramp Shift – April 5, 2021
New Ramp: Exit 4 and Permanently Closed Ramp: Exit 3B

(Washington, D.C.) - The District Department of Transportation (DDOT) will begin operations for the opening of a new ramp (Exit 4) on northbound I-295 to access South Capitol Street SE, Howard Road SE, and Nationals Park on the evening of Monday, April 5, 2021. As a result, the existing ramp (Exit 3B) will be permanently closed.

This shift will start with left or right lane closures and potential full traffic stoppages along northbound I-295, beginning at 8:00 p.m. on April 5, 2021. This will be followed by a full closure of Suitland Parkway SE between Firth Sterling Avenue SE and South Capitol Street SE starting at 9:00 p.m. The shift from the permanently closed ramp (Exit 3B) to the new ramp (Exit 4) will be completed by 5:00 a.m. on Tuesday, April 6, 2021, when all lanes of traffic will be restored.

New Ramp: Exit 4 and Permanently Closed Ramp: Exit 3B

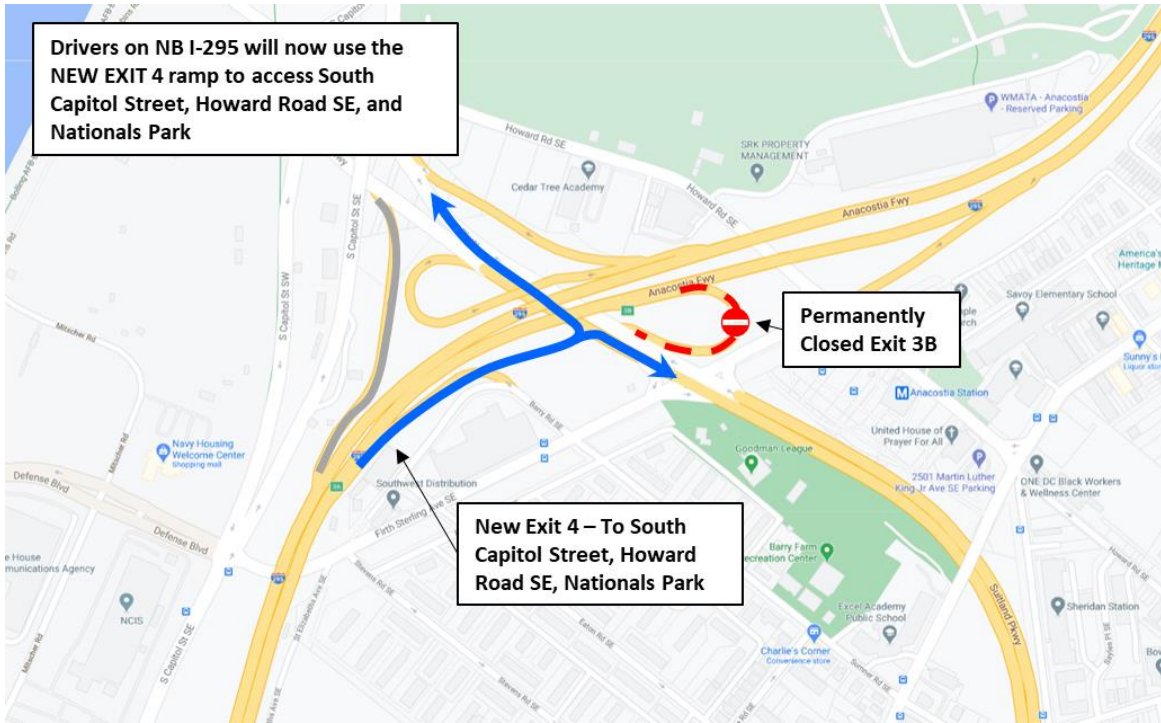

Suitland Parkway, SE Closure

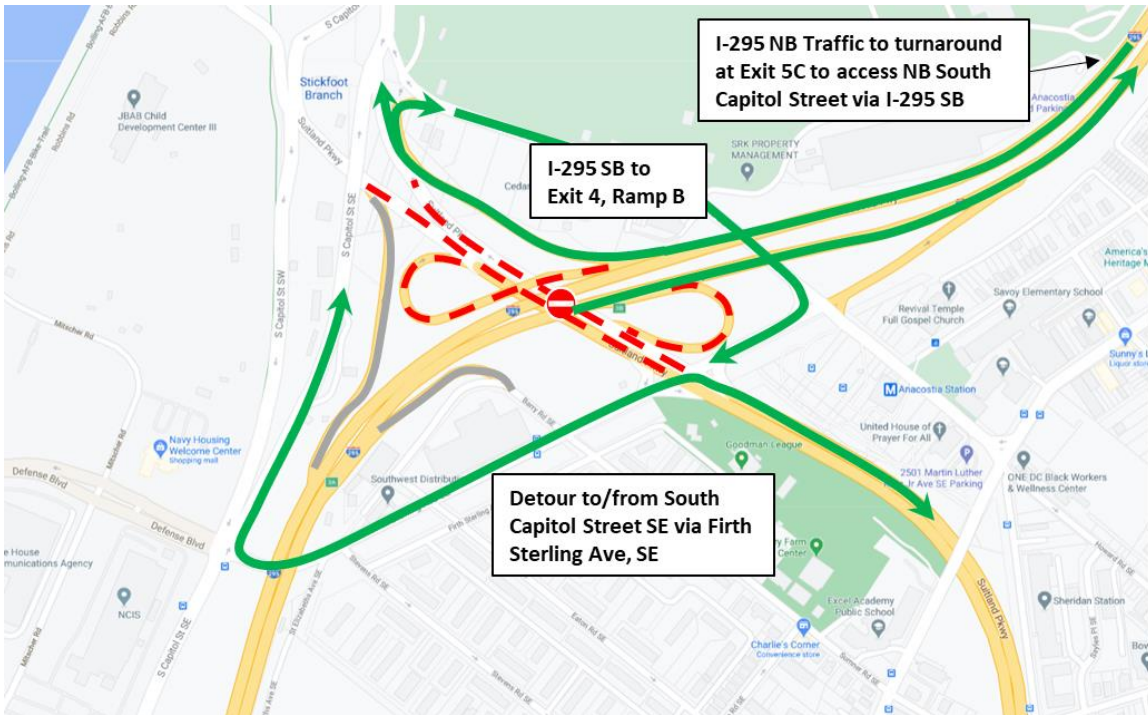

These closures are required for construction activities associated with the following DDOT project:

South Capitol Street Corridor Project - Frederick Douglass Memorial Bridge

The South Capitol Street Corridor Project calls for replacing the Frederick Douglass Memorial Bridge and transforming related sections of the urban freeway into a beautiful scenic boulevard that increases pedestrian and vehicular safety, improves multimodal transportation options, increases community accessibility and supports economic development on both sides of the Anacostia River.

Traffic controls will be in place to guide all users of the roadway through the work zones safely. Motorists should expect delays due to the lane closures and are advised to stay alert and be observant of signage and road work crews while traveling in this area.

For more information about the Frederick Douglass Memorial Bridge Project and to stay up-to-date on traffic related impacts and construction progress, please visit, visit www.newfrederickdouglassbridge.com.

###

For more information about DDOT's ongoing efforts to improve the 295 corridor, visit <http://www.improving295dc.com>.

The mission of the District Department of Transportation (DDOT) is to enhance the quality of life for District residents and visitors by ensuring that people, goods, and information move efficiently and safely with minimal adverse impact on residents and the environment.

Follow us on [Twitter](#) for transportation-related updates and more; like us on [Facebook](#) and visit the website at www.ddot.dc.gov. Visit goDCgo.com for more information on transportation options in the District.