



**For Immediate Release**

November 5, 2021

**Media Contact**

German Vigil (DDOT) – (202) 306-1668, [german.vigil@dc.gov](mailto:german.vigil@dc.gov)

## **Temporary Closure of Howard Road SE, Firth Sterling Avenue SE, and Suitland Parkway between November 6 to November 15, 2021**

**(Washington, D.C.)** - The District Department of Transportation (DDOT) will temporarily close Howard Road SE between the WMATA Parking garage and Firth Sterling Avenue SE from 5:00 a.m. to 9:00 p.m. on November 6 and November 7, 2021 for bridge construction. Pedestrian access will be continuously maintained. Access to and from the WMATA Parking Garage will be continuously maintained. When Howard Road SE is fully closed, Suitland Parkway SE will remain open to all traffic. A marked detour will be in place during these closures.

## Howard Road SE Closure & Detour

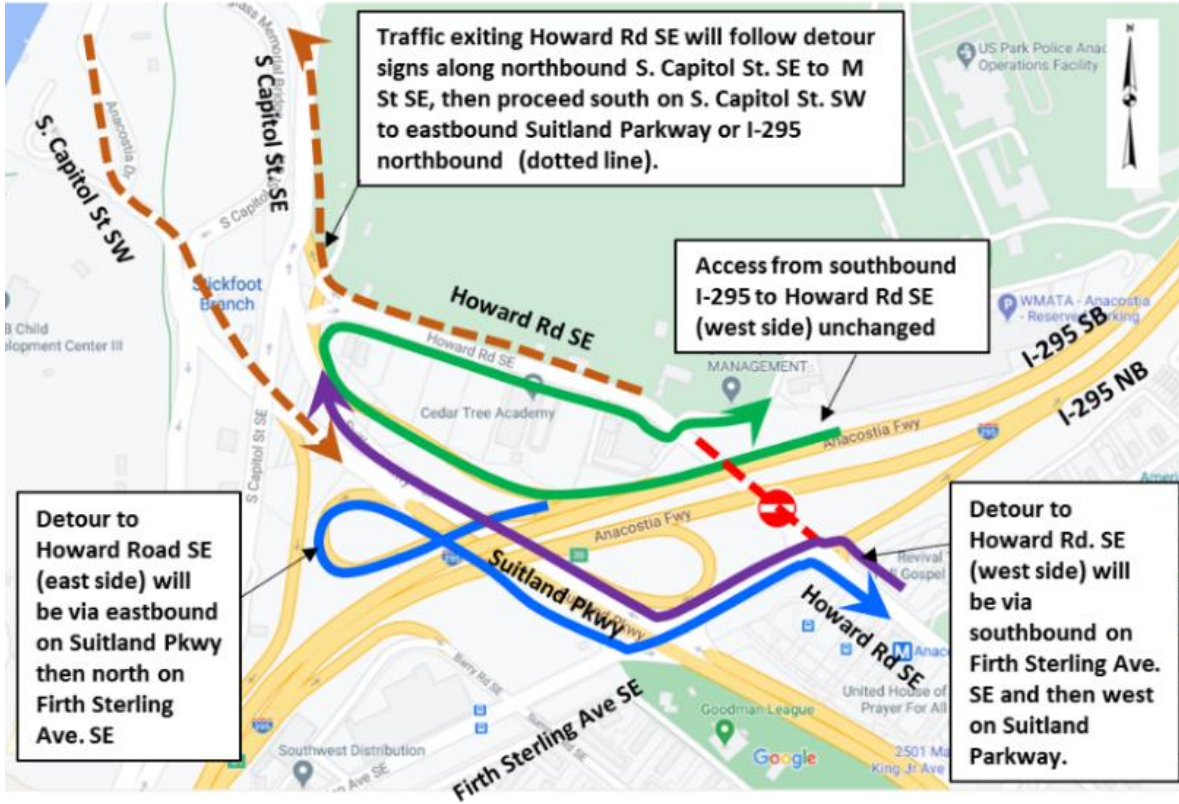

Firth Sterling Avenue SE between South Capitol Street SW and St Elizabeths Street SE will be closed from 9:00 p.m. to 5:00 a.m. the following morning from November 8 to November 11, 2021 for bridge construction. When Firth Sterling Avenue SE is fully closed, Suitland Parkway SE will remain open to all traffic. A marked detour will be in place during these closures.

### Firth Sterling Avenue SE Closure & Detour at South Capitol Street SE

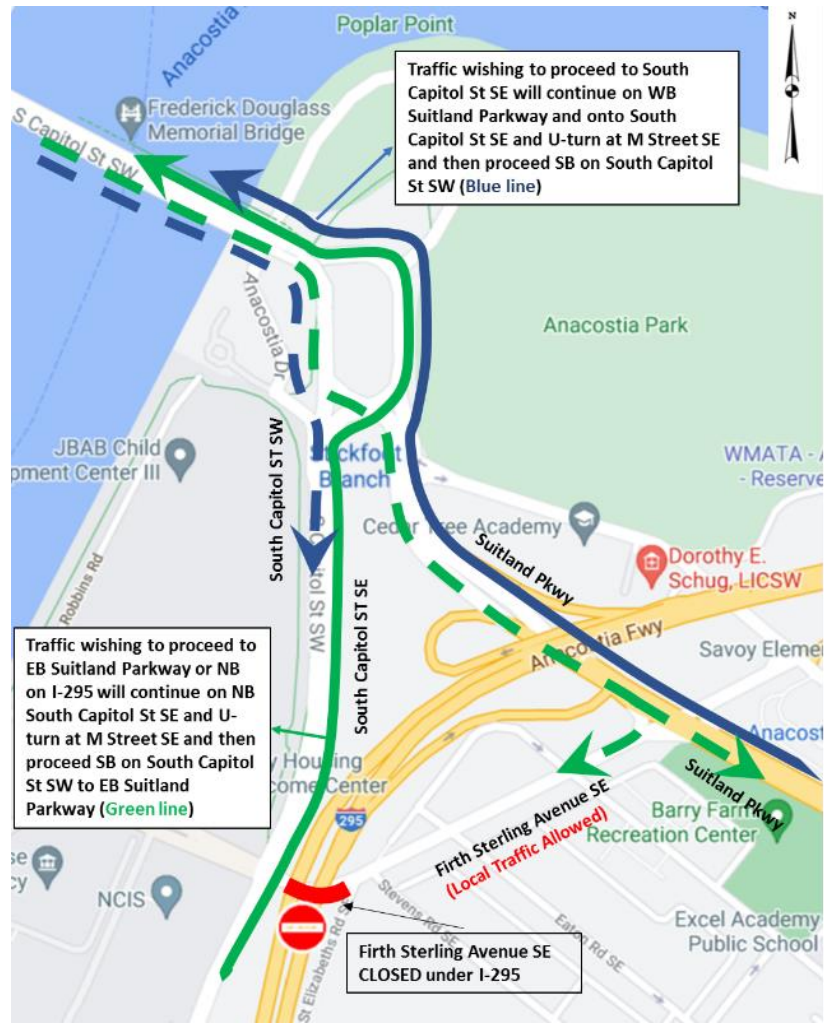

Suitland Parkway between South Capitol Street SE and Firth Sterling Avenue SE will be closed from 9:00 p.m. to 5:00 a.m. next morning from November 11 to November 13, 2021 for reconstruction. This will include the closure of Exit 4A from I-295 Southbound to outbound Suitland Parkway SE and the restriction of left turns from Exit 4 from I-295 Northbound to Suitland Parkway SE and South Capitol Street SE. When Suitland Parkway SE is fully closed, Firth Sterling Avenue SE, South Capitol Street SE, and Howard Road SE will remain open to all traffic. A marked detour will be in place during these closures.

### Suitland Parkway Closure & Detour



Firth Sterling Avenue SE between Suitland Parkway and Howard Road SE will be closed from 5:00 a.m. to 9:00 p.m. on November 13 and November 14, 2021 for re-construction. When Firth Sterling Avenue SE is fully closed, South Capitol Street SW, Suitland Parkway SE and Howard Road SE will remain open to all traffic. A marked detour will be in place during these closures.

### Firth Sterling Avenue SE Closure & Detour at Suitland Parkway

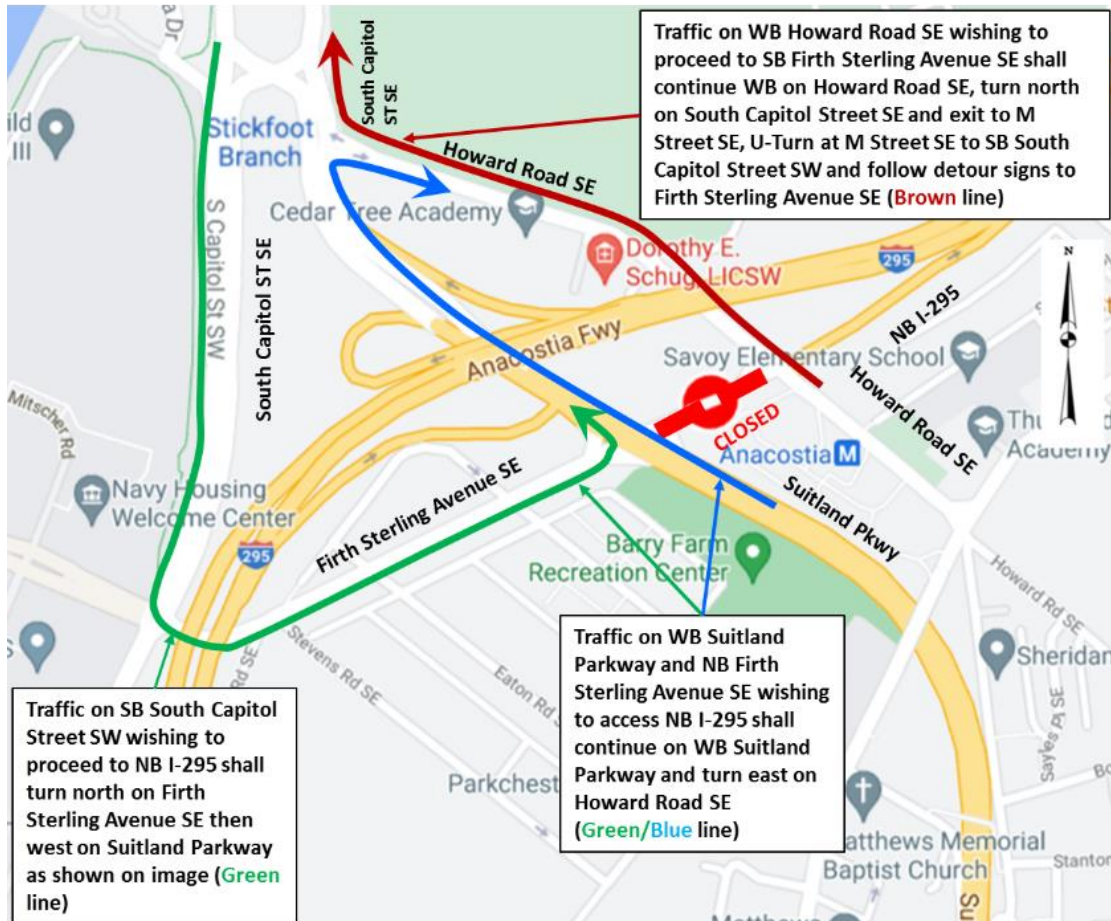

These closures are necessary for construction activities associated with the South Capitol Street Corridor Project, which includes construction of the New Frederick Douglass Memorial Bridge and the reconstruction of the I-295/ Suitland Parkway interchange.

Please observe the posted speed limit and proceed through the construction area with caution. Pedestrians and cyclists are advised to stay alert and follow signage when traveling through this area.

For more information about DDOT's ongoing efforts to improve the 295 corridors, visit [www.improving295dc.com](http://www.improving295dc.com).

###

For more information about DDOT's ongoing efforts to improve the 295 corridor, visit <http://www.improving295dc.com>.

*The mission of the District Department of Transportation (DDOT) is to enhance the quality of life for District residents and visitors by ensuring that people, goods, and information move efficiently and safely with minimal adverse impact on residents and the environment.*

*Follow us on [Twitter](#) for transportation-related updates and more; like us on [Facebook](#) and visit the website at [www.ddot.dc.gov](http://www.ddot.dc.gov). Visit [goDCgo.com](http://goDCgo.com) for more information on transportation options in the District.*